

Department of Engineering
Tim Bryan, P.E., County Engineer

3137 South Liberty Street, Canton, MS 39046
Office (601) 790-2525 FAX (601) 859-3430

MEMORANDUM

October 15, 2021

To: Sheila Jones, Supervisor, District I
Trey Baxter, Supervisor, District II
Gerald Steen, Supervisor, District III
Karl Banks, Supervisor, District IV
Paul Griffin, Supervisor, District V

From: Tim Bryan, P.E., PTOE
County Engineer

Re: AT&T of Mississippi Utility Permit
County Road Name, Ratliff Ferry Road

The Engineering Department recommends approval of permit application for AT&T of Mississippi to bore 7200' of buried fiber cable from MS 16 to Robinson Road along west side of Ratliff Ferry Road.

SHEILA JONES
District One

TREY BAXTER
District Two

GERALD STEEN
District Three

KARL BANKS
District Four

PAUL GRIFFIN
District Five

Revised: 2/14/2019



PERMIT APPLICATION FOR THE CONSTRUCTION OR ADJUSTMENT OF A UTILITY WITHIN COUNTY ROAD RIGHT-OF-WAY

Utility Information: Utility Name: AT&T Mississippi

Address: 370 Church Rd City/State/Zip: Madison

Contact Person: David Mizell Contact's Phone: 601-594-3430

Project Information: County Road Name: Ratliff Rd

(If located within more than one road right-of-way, use Appendix 1 for additional descriptions)

Beginning Location: MS 16 Ending Location: Robinson Rd

Length of Project: 7200' Section: 17 Township: 08N Range: 94C

Description of Work: Dbores 7200' of buried fiber cable from MS 16 to Robinson Rd along west side of Ratliff Ferry Rd.

Check Box if Appendix 1 is to be included as a part of this Application

Whereas the above stated Utility makes application to the **Madison County Board of Supervisors** for a Construction Permit. Attached hereto are drawings and plans for the construction of the above facilities located within Madison County owned public rights-of-way. Once stamped by the Madison County Engineering Department, these plans shall not be changed or altered without written approval of the County Engineer, or his representative. A copy of the approved permit and plans shall be on-site at all times during construction.

The Applicant Utility shall comply with all policies, procedures and construction practices as outlined in *A Policy for The Accommodation of Utility Facilities within the Right-of-Way of all Public County Roads* (hereinafter referred to as the "Policy"), as adopted on November 1, 2005, by the **Madison County Board of Supervisors**, and which is hereby made a part of this Application Agreement.

If facilities are to be located within the Rights-of-Way of the County-Federal or State Aid System, Applicant Utility also agrees to comply with applicable provisions of *S.O.P. No. SA II-2-8, Accommodation of Utilities on Rights-of-Way*, issued by the State Aid Engineer and dated July 1, 2005.

The Applicant Utility understands and agrees that, except as herein granted, no right, title, claim, or easement to said road right-of-way is granted by the issuance of this permit. If this Utility is listed in the general provisions of the Policy, it will be adjusted to comply with same without cost to the County, unless the variance from the Policy has been approved by the granting of the Permit pursuant to this Application.

The Applicant Utility further understands that the Utility's engineering, plant, or other personnel will be responsible for the staking and construction supervision of the work set out above and as shown on the attached plans. If work impacts traffic in any way, the appropriate traffic control shall be installed per the *Manual of Uniform Traffic Control Devices*, Latest Edition.

The Applicant Utility understands that the County Engineer, or his representative, may issue a Stop Work Order at any time if it is deemed that site conditions are not suitable for construction or if any of the requirements of this permit are not being met.

Many County Roads have variable Rights-of-Way and/or no Right-of-Way at all and are maintained under a Prescriptive Easement. It is the sole responsibility of the Applicant Utility to verify the existence and limits of public rights-of-way. If none exists, it is the

responsibility of the Applicant Utility to acquire an easement for their Facilities from the applicable property owner(s). **Madison County in no way verifies the limits of Right-of-Way as shown on the permit application.**

The Applicant Utility shall be responsible for all future maintenance and repair of the facilities installed under this permit. The Applicant Utility shall make future adjustments to, or relocate, the facilities located within road or highway right-of-way when required for road or highway widening or other road or highway construction at no cost to Madison County. The Applicant Utility shall relocate said utilities within sixty (60) days of notification by County by registered mail, return receipt requested, unless otherwise designated by the County Engineer. Further, any maintenance, repair, or construction shall be done in such a manner as to occasion no unreasonable interference with the normal flow and safety to traffic and at the expense of the utility company. When reasonable care has been taken to locate said utility facilities within the right-of-way, the Applicant Utility understands that any damages caused by routine maintenance and construction by County forces shall be borne by the Applicant Utility.

The Applicant Utility further agrees to indemnify and hold Madison County harmless for any and all claims, accidents, damages, liabilities and expenses occasioned wholly, or in part, by any act or omission of applicant, its agents or employees. In case County shall, without fault on its own part, be made a party to any litigation commenced by or against applicant, then applicant shall protect and hold County harmless, and shall pay all costs, expenses and reasonable attorney's fees incurred or paid by County in connection with said litigation.

All underground facilities shall be installed at a depth equal to or greater than 48" below the lowest adjacent grade.

All pipes carrying liquid shall be encased under County maintained roads.

WITNESS the signature of the Applicant this the 12 day of OCTOBER, 2021.

By: David Mizell Digitally signed by David Mizell
Date: 2021.10.12 14:08:20 -05'00'
(Applicant Signature)

Title: _____

Note: Applicant must be an employee of the Utility named in this application. The Madison County Board of Supervisors will not recognize a Contractor, Subcontractor, Agent, or Consulting Engineer as the Applicant. Utility Company shall be fully responsible for all work performed under this application.

I, or my authorized representative, have reviewed this application and determined that the drawing, sketches, and plans submitted by the Applicant meet the requirements of *A Policy for The Accommodation of Utility Facilities within the Right-of-Way of all Public County Roads.*

Plans show a min depth of fiber placement at 24". The min depth is required to be 48" at all locations on County ROW.

APPROVED
By: timothy.bryan at 11:13 am, Oct 27, 2021
Tim Bryan, P.E.
County Engineer

AGREED TO AND APPROVED BY:

Madison County Board President

Date: _____

ENTERED INTO THE MINUTES OF THE BOARD OF SUPERVISORS OF MADISON COUNTY, MISSISSIPPI ON THIS _____ DAY OF _____, 20_____.

Appendix 1

County Road Name: _____
Beginning Location: _____ Ending Location: _____
Length of Project: _____ Section: _____ Township: _____ Range: _____
Description of Work: _____

County Road Name: _____
Beginning Location: _____ Ending Location: _____
Length of Project: _____ Section: _____ Township: _____ Range: _____
Description of Work: _____

County Road Name: _____
Beginning Location: _____ Ending Location: _____
Length of Project: _____ Section: _____ Township: _____ Range: _____
Description of Work: _____

County Road Name: _____
Beginning Location: _____ Ending Location: _____
Length of Project: _____ Section: _____ Township: _____ Range: _____
Description of Work: _____

County Road Name: _____
Beginning Location: _____ Ending Location: _____
Length of Project: _____ Section: _____ Township: _____ Range: _____
Description of Work: _____

VICINITY MAP

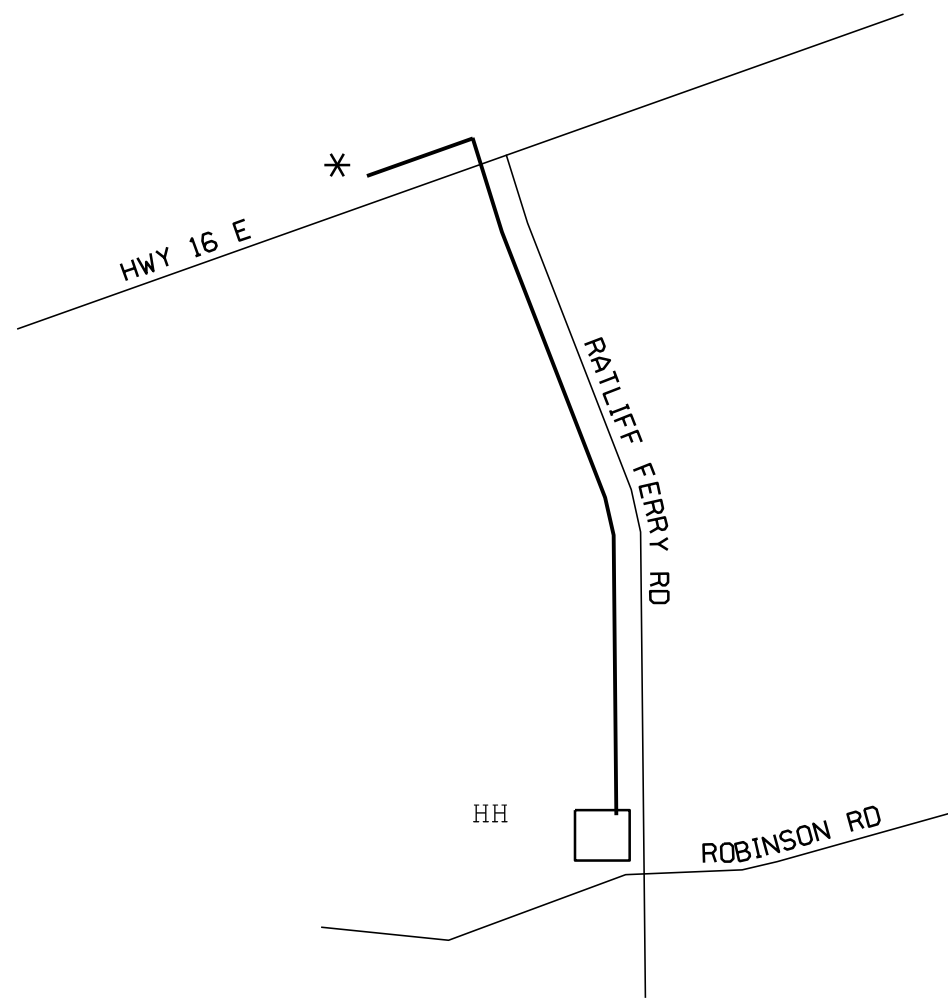

DRIVING DIRECTIONS
 FROM I-55 GO EAST ON HWY 16/PEACE ST
 FOR APPROX 19.1 MILES. TURN SOUTH ON
 RATLIFF FERRY RD.



SYMBOL LEGEND		
Proposed	Existing	Description
		AERIAL CABLE
		BURIED CABLE
		BUR JOINT-TRENCH
		BST POLE
		POWER POLE
		ANCHOR & GUY
		PUSH BRACE
		ENCLOSURE
		ENCLOSURE
		MANHOLE
		PIPE/CONDUIT
		CABLE MARKER
		AERIAL SVC WIRE
		BURIED SVC WIRE
		JOINT-TRENCH SVC
	N/A	BORE
	N/A	CUT PAVEMENT
	N/A	SPLICING PIT
200'@24"	N/A	TRENCH LEN@DEPTH

ATTSE	
PROPOSED TELEPHONE FACILITIES ON RIGHT OF WAY OF MADISON COUNTY	
RATLIFF FERRY RD	
Exchange:	601859
Designer:	MIZELL, DAVID
Phone:	601-391-3430
Authorization:	24J00012N
Dwg. <u> 1 </u> of <u> 9 </u>	

Bore Detail - NO (LOOKING WEST)

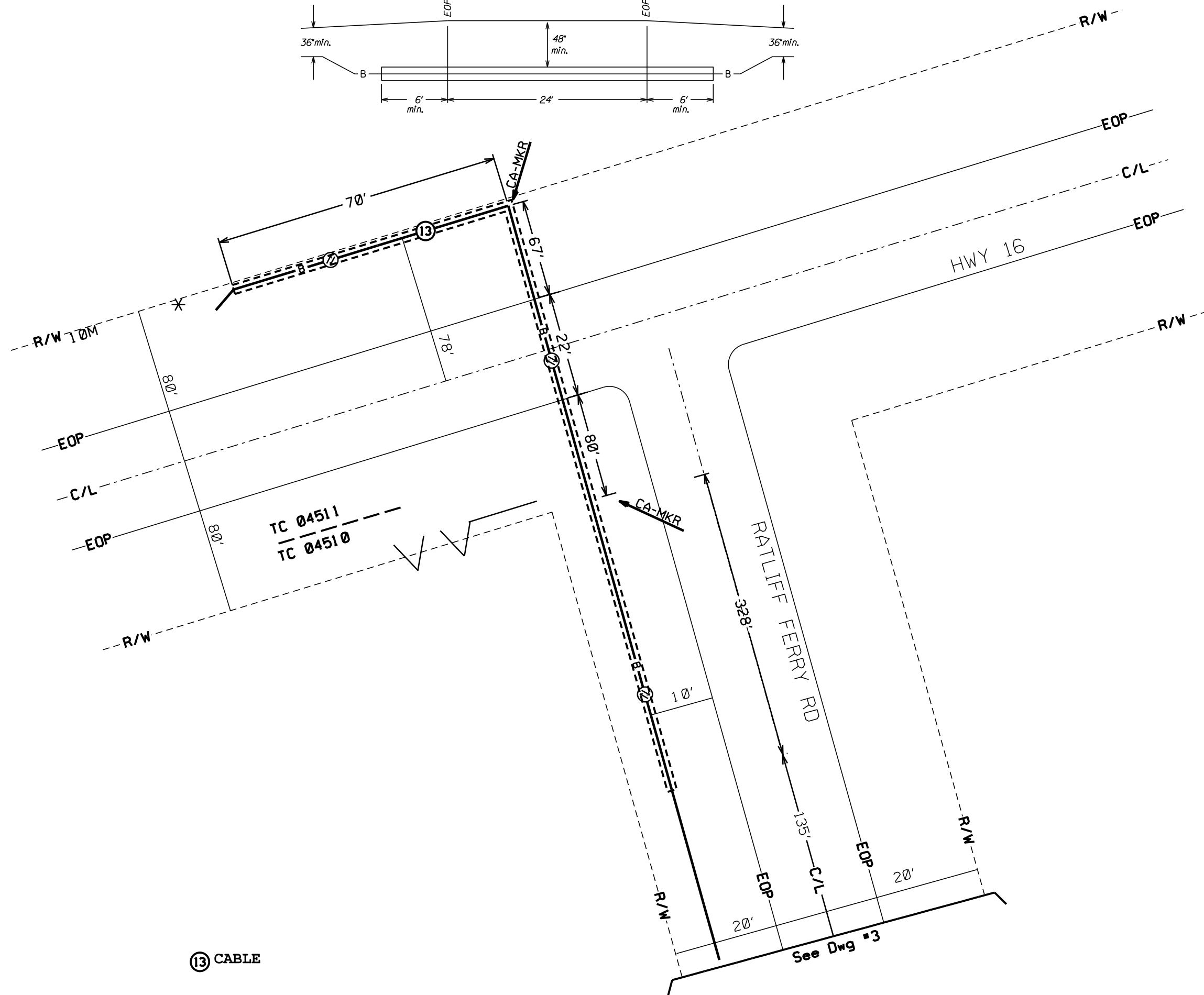
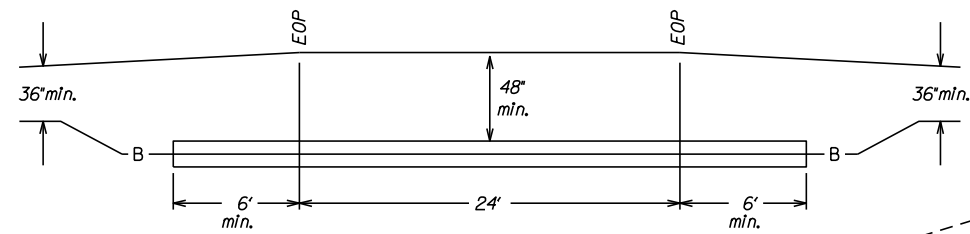

ATTSE	
PROPOSED TELEPHONE FACILITIES ON RIGHT OF WAY OF MADISON COUNTY	
RATLIFF FERRY RD	
Exchange:	601859
Designer:	MIZELL, DAVID
Phone:	601-391-3430
Authorization:	24J00012N
Dwg. <u> 2 </u> of <u> 9 </u>	

⑬ CABLE

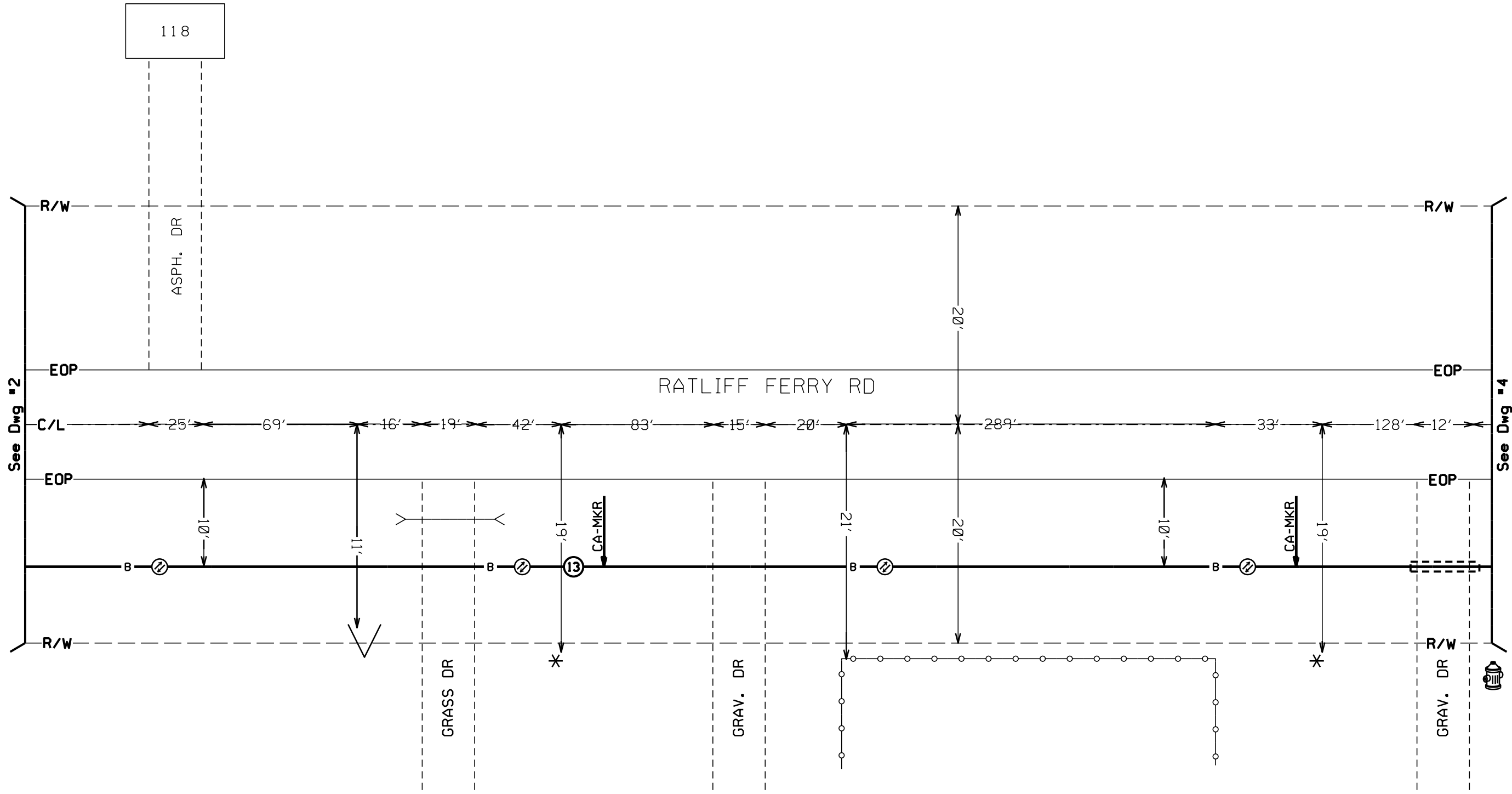

See Dwg #2

See Dwg #4

ATTSE	
PROPOSED TELEPHONE FACILITIES ON RIGHT OF WAY OF MADISON COUNTY	
RATLIFF FERRY RD	
Exchange:	601859
Designer:	MIZELL, DAVID
Phone:	601-391-3430
Authorization:	24J00012N
Dwg. <u> 3 </u> of <u> 9 </u>	

⑬ CABLE

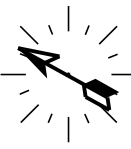

168

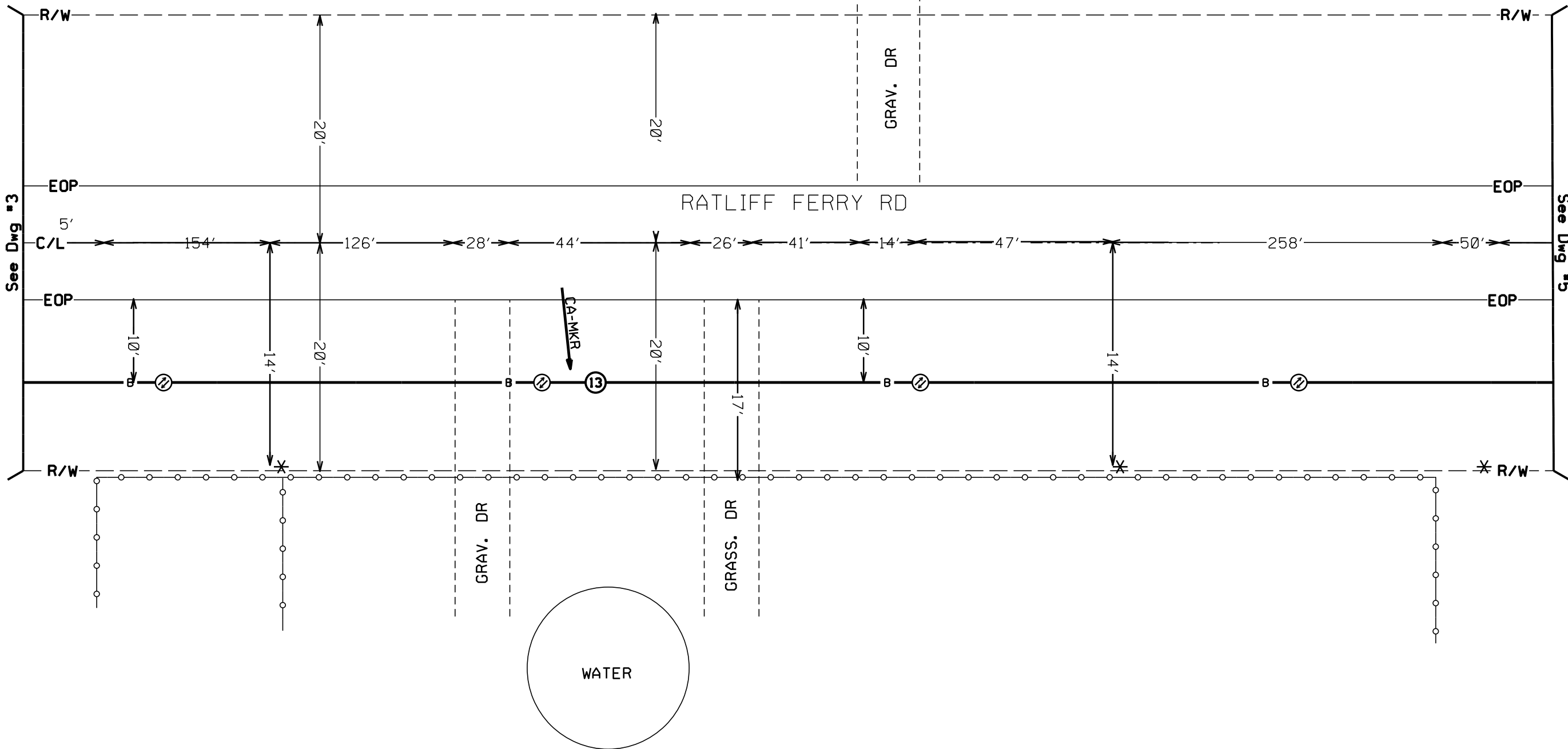

ATTSE	
PROPOSED TELEPHONE FACILITIES ON RIGHT OF WAY OF MADISON COUNTY	
RATLIFF FERRY RD	
Exchange:	601859
Designer:	MIZELL, DAVID
Phone:	601-391-3430
Authorization:	24J00012N
Dwg. <u>4</u> of <u>9</u>	



⑬ CABLE

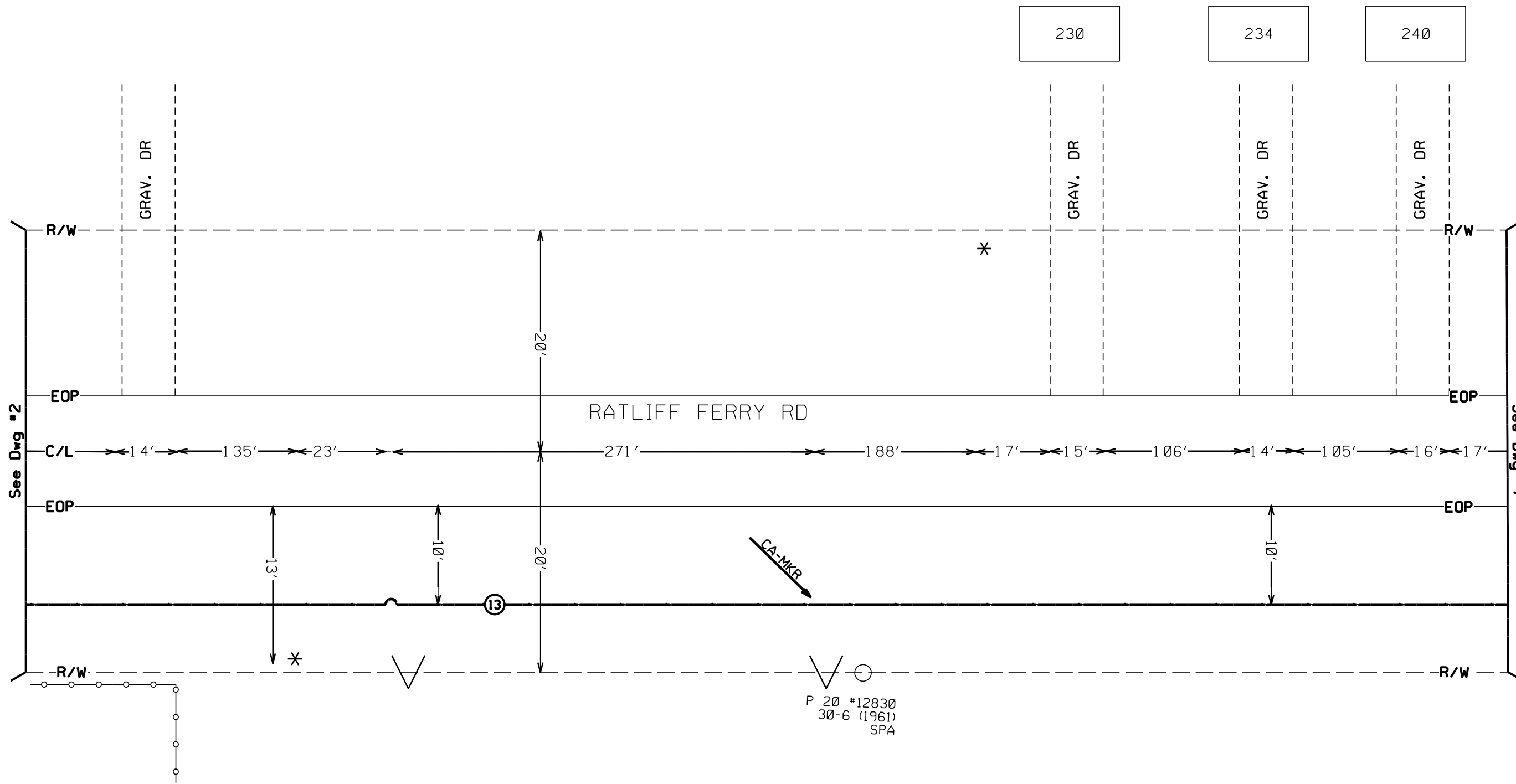

See Dwg #2

See Dwg #7

ATTSE	
PROPOSED TELEPHONE FACILITIES ON RIGHT OF WAY OF MADISON COUNTY	
RATLIFF FERRY RD	
Exchange:	601859
Designer:	MIZELL, DAVID
Phone:	601-391-3430
Authorization:	24J00012N
Dwg. <u>6</u> of <u>9</u>	

Bore Detail - (LOOKING WEST)



⑬ CABLE

⑭ CABLE

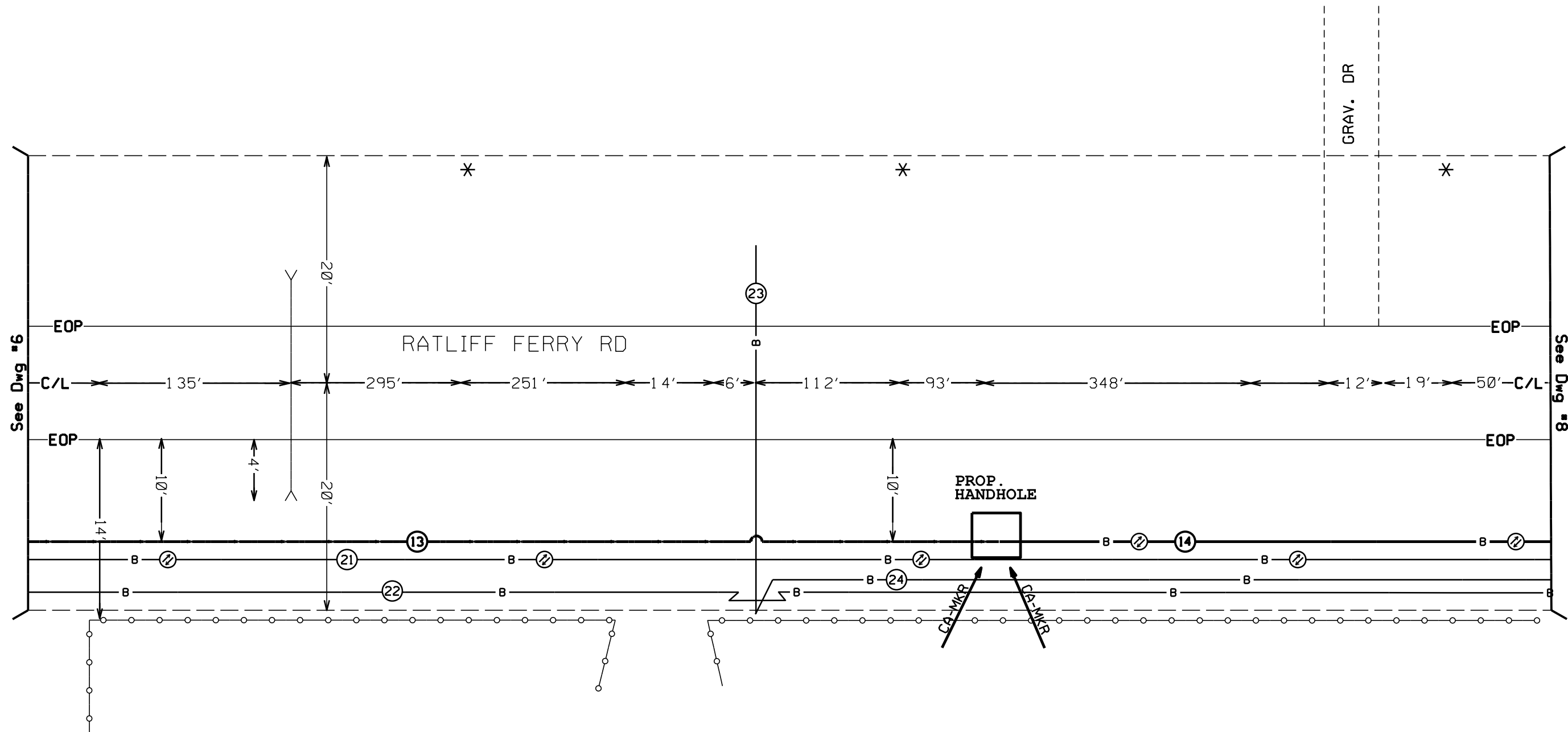
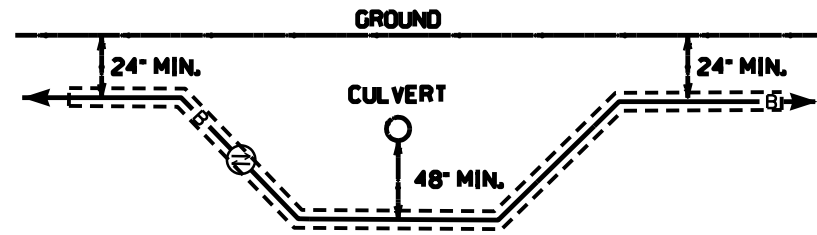

See Dwg #6

See Dwg #8

ATTSE

PROPOSED TELEPHONE FACILITIES
ON RIGHT OF WAY OF
MADISON COUNTY

RATLIFF FERRY RD

Exchange:
601859

Designer:
MIZELL, DAVID

Phone:
601-391-3430

Authorization:
24J00012N

Dwg. 7 of 9

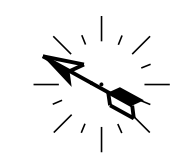

⑭ CABLE

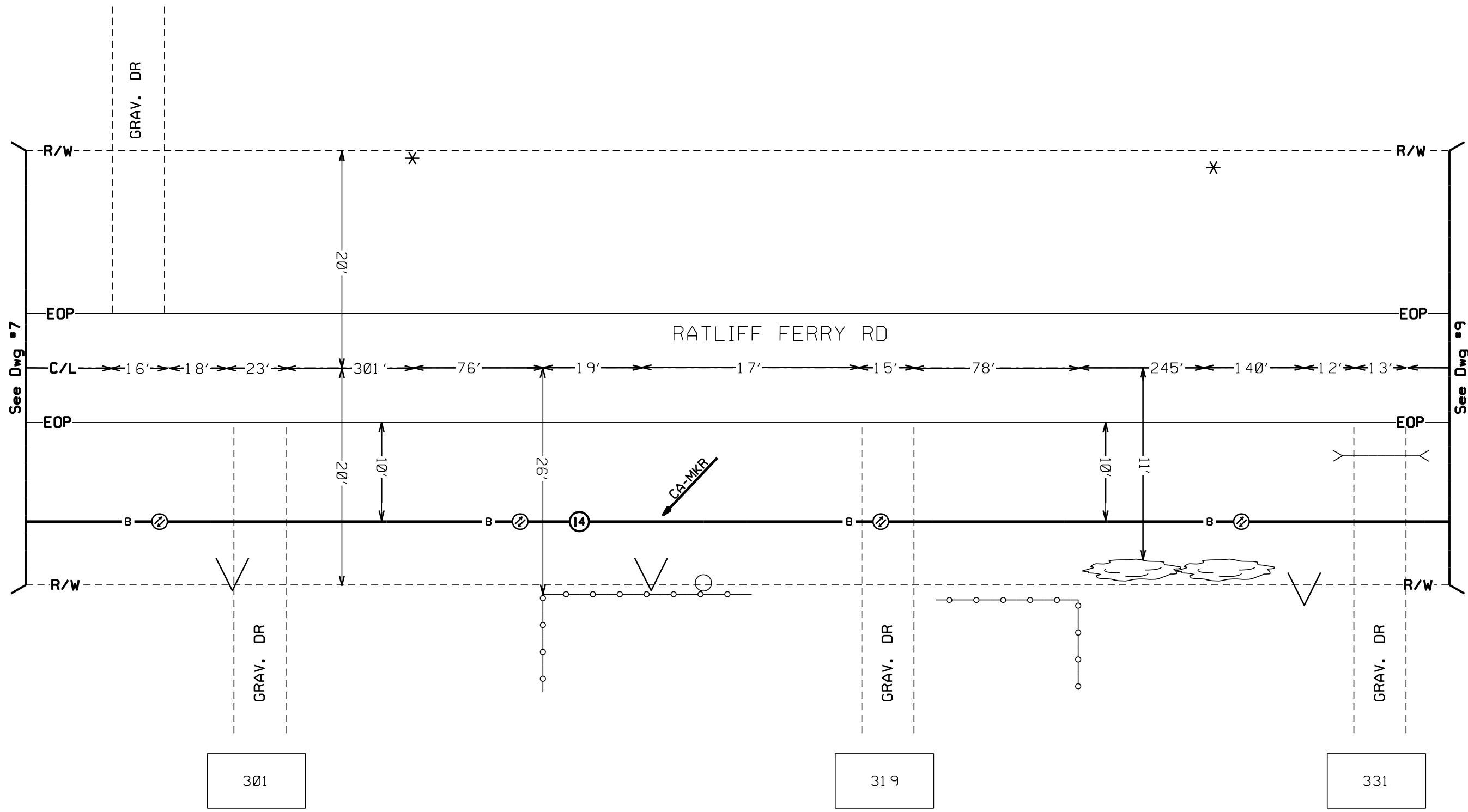

ATTSE	
PROPOSED TELEPHONE FACILITIES ON RIGHT OF WAY OF MADISON COUNTY	
RATLIFF FERRY RD	
Exchange:	601859
Designer:	MIZELL, DAVID
Phone:	601-391-3430
Authorization:	24J00012N
Dwg. <u> 8 </u> of <u> 9 </u>	

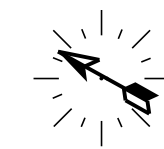

Bore Detail - (LOOKING WEST)

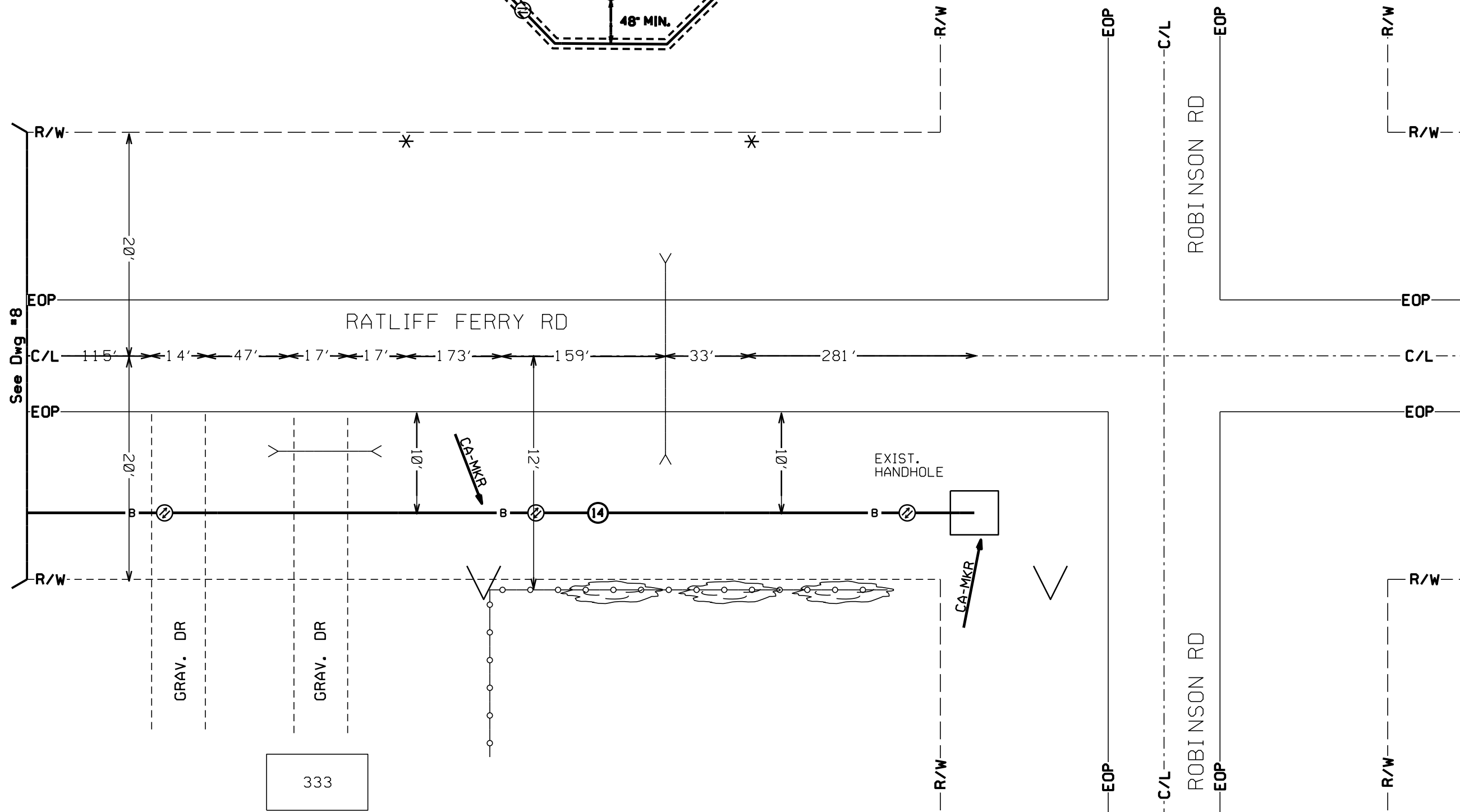
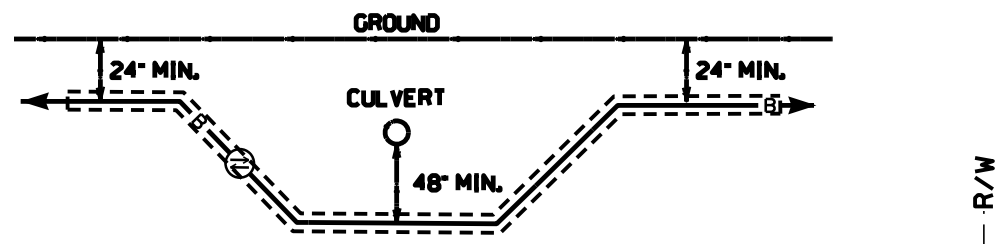

ATTSE	
PROPOSED TELEPHONE FACILITIES ON RIGHT OF WAY OF MADISON COUNTY	
RATLIFF FERRY RD	
Exchange:	601859
Designer:	MIZELL, DAVID
Phone:	601-391-3430
Authorization:	24J00012N
Dwg.	9 of 9